

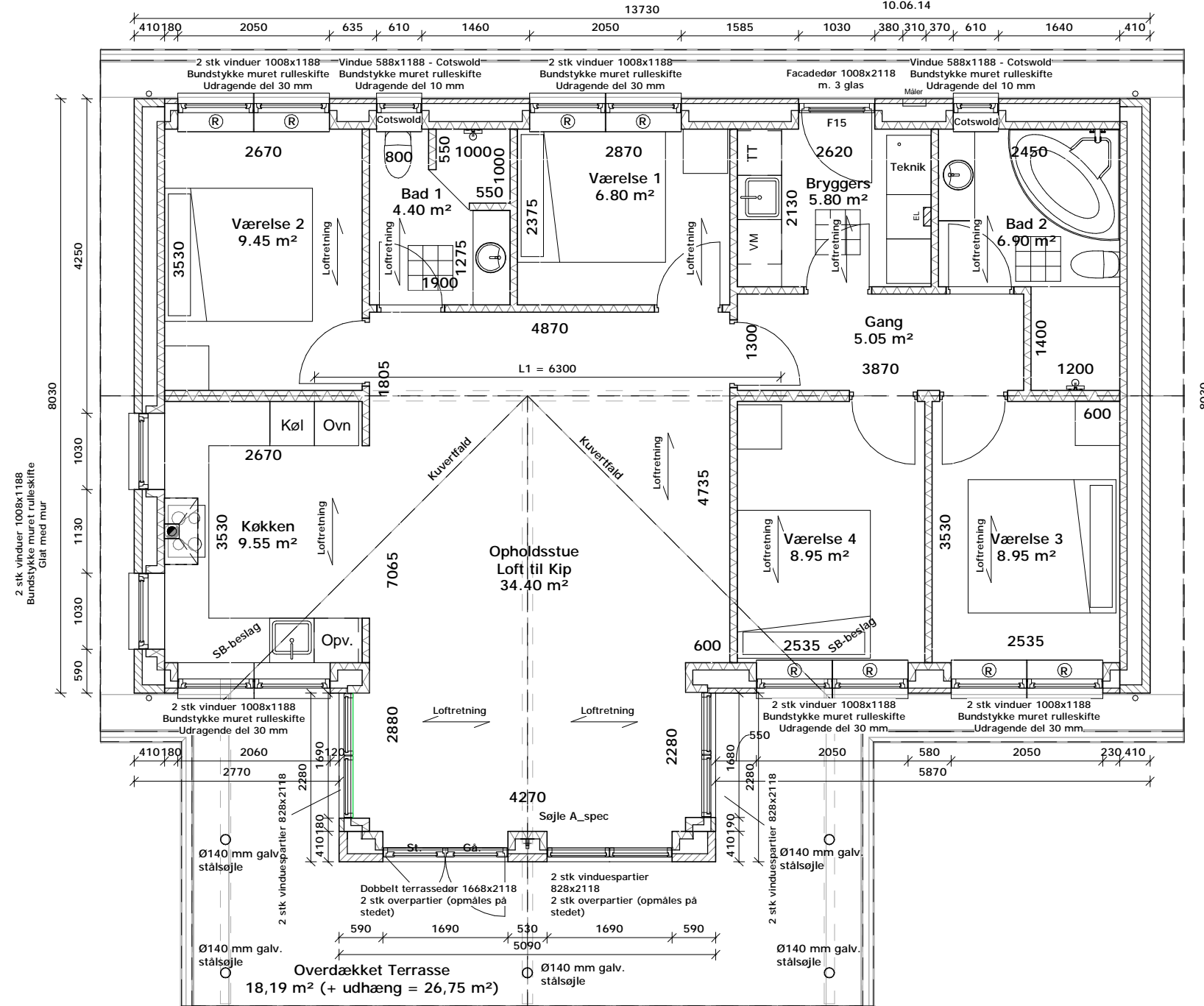

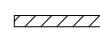

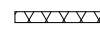



Bygh. kontakten ang  
 placering af indv. elgruppe  
 tavle og udv. elmåler d.  
 10.06.14

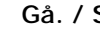

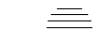
## Loft til Kip i hele huset

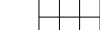
OPFØRES EFTER BR10 MED  
 KL 2015 ISOLERING  
 (GÆLDENDE FOR KLIMASKÆRMEN)

-  Teglsten
-  Gasbeton
-  Tagnedløb
-  Gå. / St. Gående- / Stående dørblad
-  Gulvtæppe
-  Trægulvsretning
-  Fliseforbåndt og fliseretning
-  ® Redningsåbning
-  \* Placering af loftlem tilpasses vindtræksbånd

HV

Byggeadr.:	Avernakøvej 2, 5600 Faaborg		Sagsnr.:	Tegn nr.:	
Bygherre:	Dansk skovprodukt v/Ludvig og Gunhild Hansen Hornenæs skov 4, 5600 Faaborg		214060		
Emne:	Grundplan	Dato:	10.06.14	Tegn:	RVS
Matr.nr.:	5fn	Type:	121,9/22,9	Mål:	1 : 75
<b>2</b>					
Copyright ©					
ØRBÆKVEJ 268B, 5220 ODENSE SØ					
TLF. 65 92 75 55 FAX. 65 92 77 73					